

Fig No:DA314 / SR314

1/2" ~ 2" (DN 15~ DN 50)

DA:Double Acting SR:Spring Return



Valve Specification :

Design specification according to EN 12516-3

L-Port / T-Port , Four Seat design

Material : Stainless Steel, Carbon Steel or Special Alloy upon request

Blow-out-proof stem design , Anti-static design

Actuator mounting shall be in accordance with ISO 5211

End Connection:Threaded / Socket Weld / Butt Weld / Flanged

Working Pressure (CWP) : 1000 Psi

Temperature Range : -4 to 356 °F (-20 to 180 °C)

Pressure Test According to API 598

Shell test by water : 1500 Psi

Closure seat by Air : 80 Psi ~ 100 Psi

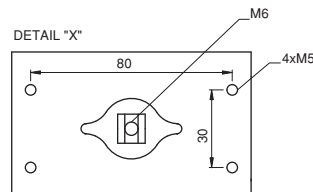

PORT TYPE	1	2	3	4
L	1/3 2	1/3 2	1/3 2	1/3 2
T	1/3 2	1/3 2	1/3 2	1/3 2

MATERIALS LIST

NO	PART NAME	MATERIAL	Q'TY
1	BODY	ASTM A351 GR. CF8M	1
2	BALL	ASTM A351 GR. CF8M	1
3	END CAP	ASTM A351 GR. CF8M	3
4	BODY SEAL	PTFE.	3
5	STEM	SS316	1
6	FOLLOWER	SS304	1
7	STEM PACKING	PTFE.	1 SET
9	SEAT	PTFE.	4
10	THRUST WASHER	PTFE.	1
17	STEM NUT	SS304	1
20-1	END CAP BOLT	SS304	4~12
20-2	BOLT	SS304	4
21	BEVELILLE WASHER	SS301	1 SET
29	BOLT WASHER	SS304	4~12
39	PNEUMATION ACTUATOR	ALUMINUM	1

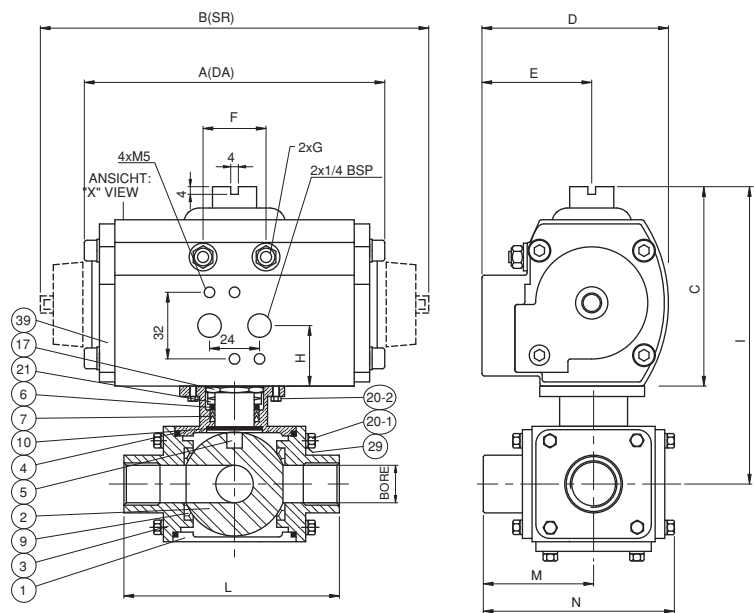

DIMENSIONS

Unit:mm

SIZE	1/2"		3/4"		1"		1-1/4"		1-1/2"		2"	
Air Supply	80 PSI		80 PSI		80 PSI		80 PSI		80 PSI		80 PSI	
ACTUATOR	DA	SR	DA	SR	DA	SR	DA	SR	DA	SR	DA	SR
	C-125	C-250 SR4	C-250	C-450 SR3	C-250	C-1000 SR3	C-450	C-1000 SR3	C-450	C-2250 SR3	C-1000	C-2250 SR2
BORE	16.0		20.0		25.0		32.0		38.0		50.0	
A	120.0	**	144.3	**	144.3	**	149.2	**	149.2	**	183.0	**
B	**	194.6	**	205.6	**	250.0	**	250.0	**	355.0	**	355.0
C	84.0	99.0	99.0	118.0	99.0	141.0	118.0	141.0	118.0	161.0	141.0	161.0
D	62.2	81.4	81.4	95.0	81.4	119.0	95.0	119.0	95.0	140.0	119.0	140.0
E	33.7	47.8	47.8	51.5	47.8	64.5	51.5	64.5	51.5	75.5	64.5	75.5
F	24.0	32.5	32.5	32.5	32.5	46.2	32.5	46.2	32.5	54.0	46.2	54.0
G	MxP0.8	M5xP0.8	M5xP0.8	M6xP1.0	M5xP0.8	M8xP1.25	M6xP1.0	M8xP1.25	M6xP1.0	M10xP1.5	M8xP1.25	M10xP1.5
H	23.5	29.7	29.7	30.2	29.7	33.5	30.2	33.5	30.2	39.0	33.5	39.0
I	150.2	165.2	177.2	196.2	202.0	225.0	216.9	239.9	226.5	249.5	266.7	286.7
L	96.0		107.0		126.0		133.0		151.0		166.0	
M	48.0		53.5		63.0		66.5		75.5		83.0	
N	90.0		99.5		120.0		127.0		146.0		159.5	