

**Fig No: PNU-KGV**

1/2" ~ 12" ( DN 15 ~ DN 600 )



Knife Gate Valve  
 Outside Screw & Yoke  
 Rising Stem  
 In accordance with TAPPI standard TIS405-8  
 And MSS SP-81  
 Size: 2"~24"  
 Connection: JIS 5K/ JIS 10K/ ANSI 150/ PN10/ PN 16  
 Gear Operation  
 Option:  
 Chain/ Gear/ Electric/ Pneumatic/ Hydraulic operation

	BADY	PLATE	SEAT	GLAND PACKING
<b>MATERIAL</b>	FC WCB SCS 13 SCS 14 SCS 16	SUS 304 SUS 316 SUS 304L SUS 316L	TEFLON MAT'L VITON EPDM	NON-ASB+TFE ASB ASB+PTFE TEFLON NON ASBESTOS

## MATERIALS LIST

NO.	SUBJECT	MATERIAL
1	BODY	FC, FCD
2	SHUT PLATE	SUS304
3	STEM	SS41+HCR
4	SEAT	TEFLON
5	GRAND	CAST IRON
6	GLAND PACKING	ASB NON-ASB
7	YOKE	DUCTILE IRON
8	POINTER	SS304
9	NUT	SS304
10	NUT	SS304
11	CONNECTOR	SS304
12	BOLT AND NUT	MILD STEEL
13	ACTUATOR	AL ALLOY FC
14	GUIDE	CAST IRON

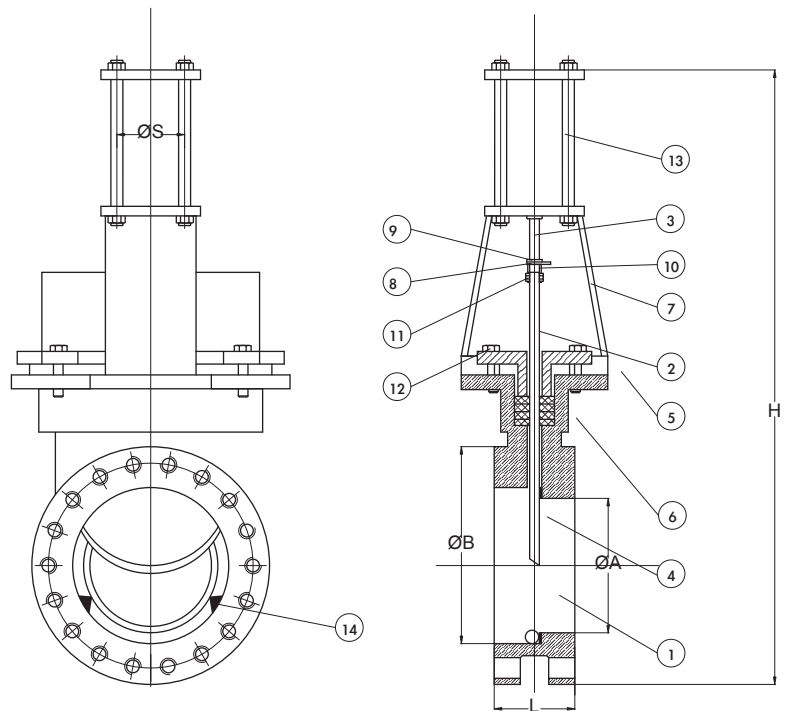

## DIMENSIONS

SIZE	2"	2-1/2"	3"	4"	5"	6"	8"	10"	12"	14"	16"	18"	20"	24"
L	55.0	55.0	55.0	55.0	60.0	60.0	70.0	75.0	80.0	80.0	90.0	95.0	120.0	120.0
ØA	42.0	57.0	72.0	82.0	116.0	138.0	192.0	232.0	280.0	345.0	395.0	445.0	490.0	590.0
ØB	64.0	80.0	95.0	114.0	141.0	161.0	213.0	261.0	315.0	376.0	425.0	480.0	520.0	630.0
ØS	63.0	63.0	80.0	125.0	125.0	150.0	180.0	200.0	250.0	250.0	250.0	250.0	300.0	300.0
H	590.0	600.0	650.0	720.0	870.0	940.0	1190.0	1440.0	1560.0	1840.0	2060.0	2200.0	2460.0	2750.0

Unit:mm